

ZFB Series

Universal Vacuum Filter

AIRBEST



Features

- ◇ Filter dust and other particles from the vacuum port
- ◇ Transparent housing, easy to check the degree of contamination
- ◇ Filter elements could be replaced
- ◇ Different nominal flow for option
- ◇ Suitable for vacuum system with light and medium pollution level
- ◇ Could be used for as prefilter, it can effectively filter dust with different degrees



How to order

ZFB 15 B
① ② ③

| ① Series | ② Connection thread | ③ Bracket |
|------------|--|---------------------------|
| ZFB | 10 - G3/8 female thread 15 - G1/2 female thread 20 - G3/4 female thread 25 - G1" female thread 40 - G1 1/2 female thread | B - Default, with bracket |

Selection

| Model/Connection thread | | | | |
|-------------------------|-----------|-----------|----------|-------------|
| 10 - G3/8 | 15 - G1/2 | 20 - G3/4 | 25 - G1" | 40 - G1 1/2 |
| ZFB10B | ZFB15B | ZFB20B | ZFB25B | ZFB40B |

Technical parameters

| Model | Rated operating pressure range kPa | Material | Nominal flow NL/min | Internal volume cm ³ | Filter area m ² | Removal efficiency μm | Working temperature °C | Weight g |
|--------|------------------------------------|------------|---------------------|---------------------------------|----------------------------|-----------------------|------------------------|----------|
| ZFB10B | -100~0 | PA, PC, PE | 150 | 45 | 0.003 | 10 | -20~80 | 70 |
| ZFB15B | -100~0 | PA, PC, PE | 900 | 195 | 0.010 | 10 | -20~80 | 168 |
| ZFB20B | -100~0 | PA, PC, PE | 900 | 205 | 0.010 | 10 | -20~80 | 170 |
| ZFB25B | -100~0 | PA, PC, PE | 2,520 | 495 | 0.019 | 10 | -20~80 | 424 |
| ZFB40B | -100~0 | PA, PC, PE | 5,100 | 675 | 0.023 | 10 | -20~80 | 550 |

ZFB Series

Universal Vacuum Filter

AIRBEST

Dimensions (mm)

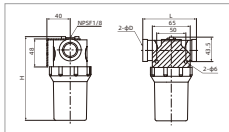

ZFB10(15-20)B

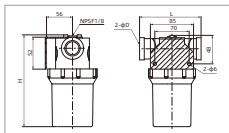

ZFB25B ZFB40B

Repair kits



| Model/Size | H | L | D |
|------------|-------|------|--------|
| ZFB10B | 74.5 | 76.5 | 2-G3/8 |
| ZFB15B | 134.5 | 91.5 | 2-G1/2 |
| ZFB20B | 143.5 | 92 | 2-G3/4 |

| Model/Size | H | L | D |
|------------|-------|-----|----------|
| ZFB25B | 169.5 | 127 | 2-G1* |
| ZFB40B | 212.5 | 127 | 2-G1*1/2 |

| Item | Model | Size | Applicable vacuum filter |
|----------------|----------|-------------|--------------------------|
| Filter element | ZFB10-FE | 15×26×L35 | ZFB10 |
| | ZFB20-FE | 27.5×39×L90 | ZFB15、20 |
| | ZFB25-FE | 45×57×L104 | ZFB25 |
| | ZFB40-FE | 45×57×L136 | ZFB40 |

○ Note: The minimum packing quantity of filter element is 10pcs/bag

Vacuum Accessories

ZFS
ZFA
ZFE
ZFD
ZFB
ZFL
ZFP
ZVAB
ZVAC
ZVRA
ZVEA
ZVR
ZVRH
ZVCM
ZVDM
ZVT
ZVS
ZPOT
ZPDE
ZPMR
ZSA