

SNT Series

AIRBEST

Non-contact Suction Cup



COMPOSITE
MATERIAL



POROUS

Features

- ◇ The suction cup "floats" on the air cushion during the gripping
- ◇ Low vacuum level, large vacuum flow
- ◇ Vacuum created based on Bernoulli principle
- ◇ No air go through the workpiece

Advantages

- ◇ To achieve non-contact handling of workpiece
- ◇ Good compensation of air leakage
- ◇ Safely separates thin and porous workpiece
- ◇ Connect to compressed air directly, no need extra vacuum generator



Application

- ◇ Fragile workpieces, such as silicon wafer, solar cell
- ◇ Porous workpieces, such as printed PCB, PVC board, textile
- ◇ Thin and light workpieces, such as plastic film, paper

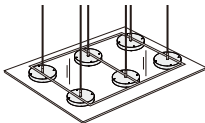

Structure

- ◇ There are 4 threaded holes on the top
- ◇ Air supply ports on both vertical and horizontal side

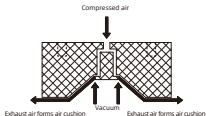

Special Vacuum Grippers

SLG

SNC

SNT

SLP

SLB

SLW

SLF

How to order

SNT 30 - S N

① ② ③ ④

① Series	② Diameter	③ Flow type	④ Cushion material
SNT	20 - $\phi 20$ mm	60 - $\phi 60$ mm	S - Standard flow
	30 - $\phi 30$ mm	100 - $\phi 100$ mm	N - NBR (not available in SNT20)
	40 - $\phi 40$ mm	120 - $\phi 120$ mm	PK - PEEK (Mark free)
			PM - POM (Food grade) (Only available in SNT20)

Selection

Model/Diameter	20	30	40	60	100	120
-	SNT30-SN	SNT40-SN	SNT60-SN	SNT100-SN	SNT120-SN	
SNT20-SPK	SNT30-SPK	SNT40-SPK	SNT60-SPK	SNT100-SPK	SNT120-SPK	
SNT20-SPM	-	-	-	-	-	-

Technical parameters

Model	Pull-out force N	Air supply pressure bar	Max. air consumption NL/min	Working temperature °C	Weight g	Recommended hose dia. mm
SNT20	2	5.0	80	0~60	9.5	6
SNT30	4	5.0	100	0~60	32	8
SNT40	6.5	5.0	130	0~60	51	8
SNT60	17	5.0	225	0~60	116	6
SNT100	55.5	5.0	420	0~60	252	8
SNT120	104	5.0	420	0~60	331	8

○ Note: The tested workpiece is rigid and airtight, air supply pressure range is 1.0 - 6.0bar, vertical action. The specified pull-out force does not include the safety factor

Dimensions(mm)

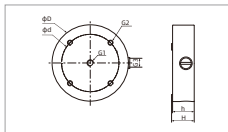

SNT

Model/Size	D	d	H	h	G1	G2	G3
SNT20	20	15	12.8	12	M5x0.8	4-M3x0.5depth5	-
SNT30	32	22	17.8	17	M5x0.8	4-M4x0.7depth6	M5x0.8
SNT40	40	32	17.8	17	G1/8	4-M4x0.7depth6	G1/8
SNT60	60	45	17.8	17	G1/8	4-M4x0.7depth6	G1/8
SNT100	100	75	17.8	17	G1/8	4-M4x0.7depth6	G1/8
SNT120	120	105	17.8	17	G1/8	4-M4x0.7depth6	G1/8