

SFK Series

AIRBEST

Flat Suction Cup Special for Objects with Rough Surface



METAL SHEET



GLASS



WOOD

RoHS

Suction Cup

Features

- Sealing ring is made of flexible EPDM foam rubber
- Internal large area support structure
- Small inner volume
- Various sizes are available

Advantages

- Suitable for workpieces with rough or uneven surfaces
- Slipping resistance. Prevent thin workpiece from permanent deformation
- Short work cycle
- Suitable for workpieces with different sizes and shapes

Applications

- Handling workpieces with uneven surfaces, such as embossed steel plate, decorative glass, rough slate, wooden plate, etc.
- Touch valve is optional, which will close vacuum chamber when it detects that suction cups do not contact workpieces, in order to avoid vacuum leakage

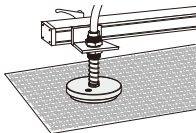

Structure

- Split structure design, wearing parts can be replaced separately
- Separate functional part is equipped

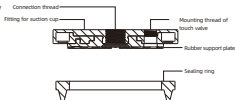

- Note: The functional threaded hole is sealed with a plug when delivered. Seal the thread with thread glue or raw tape when connecting

SZ
SP3
SUR
SAN
SAO
SOFA
STP
SFT
SFA
SST
SEL
SBLP
SBS
SFP
SEP
SGP
SGOF
STC
SFF
SOB
SOF
SGG
SFM
SOM
SEF
SOM
SFK
SHT
SDL
SPG
SFGT
SPD
SB
SBA
SF
SU
SP2P
SPA
SPD
SFF
SPC
SPJ
SPU
SH
SHB
SHB
SOP
SNP

SFK Series

AIRBEST

Flat Suction Cup Special for Objects with Rough Surface

How to order

SFK 110 E - G4F - V

① ② ③ ④ ⑤

① Series	② Diameter	③ Material & Hardness	④ Connection thread	⑤ Special specification
SFK	110 - ϕ 110mm 160 - ϕ 160mm 200 - ϕ 200mm 250 - ϕ 250mm	E - EPDM	Nil - Sealing ring only G4F - G1/2 female thread	Nil - Standard V - With touch valve

Selection

Model	Connection thread F - Female thread
SFK110E	SFK110E-G4F SFK110E-G4F-V
SFK160E	SFK160E-G4F SFK160E-G4F-V
SFK200E	SFK200E-G4F SFK200E-G4F-V
SFK250E	SFK250E-G4F SFK250E-G4F-V

Technical parameters

Model	Pull-out force N	Inner volume cm ³	Min.curve radius of workpiece mm	Weight g	Recommended hose dia. mm	MPQ pcs
SFK110	480	70	300	465	10	1
SFK160	1080	145	600	935	10	1
SFK200	1800	225	1000	1445	12	1
SFK250	2800	360	1500	2225	12	1

○ Note: Testing vacuum level -60kPa, workpiece with smooth and clean surface. The data of pull-out force as above are figured out without considering safety factor. The data may be different according to different workpiece surfaces. Recommend the length of vacuum hose to be as short as possible, max 2m.

Dimensions(mm)

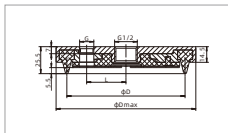

SFK110-250

Model/Size	Dmax	D	G	L
SFK110E-G4F	130	110	G1/4	36.5
SFK160E-G4F	179	160	G1/4	36.5
SFK200E-G4F	219	200	G1/2	76
SFK250E-G4F	269	250	G1/2	76

Flat Suction Cup Special for Objects with Rough Surface

Dimensions(mm)

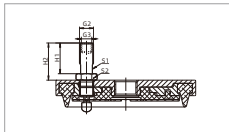

SFK110-250

Model/Size	G2	G3	H1	H2	S1	S2
SFK110E-G4F-V	G1/4	G1/8	27.5	33.5	11	17
SFK160E-G4F-V	G1/4	G1/8	27.5	33.5	11	17
SFK200E-G4F-V	G1/2	G3/8	29.5	37.5	19	27
SFK250E-G4F-V	G1/2	G3/8	29.5	37.5	19	27

- Note: 1. The dimensional tolerance conforms to GB/T3672.1-2002-1 M3 rubber product dimensional tolerance standard
 2. The height of the touch valve contact beyond the suction cup lip can be adjusted by itself according to the actual application.
 Locking the nut after height position is determined.
 Applicable thread nut size should be applied to the thread connection of touch valve and fitting for suction cup

Accessories

Item	Model	Applicable suction cup
Touch valve	ZVD-G2M	SFK110,160
	ZVD-G4M	SFK200,250